

INSTRUCTIONS

CARO CHEST CHANGER

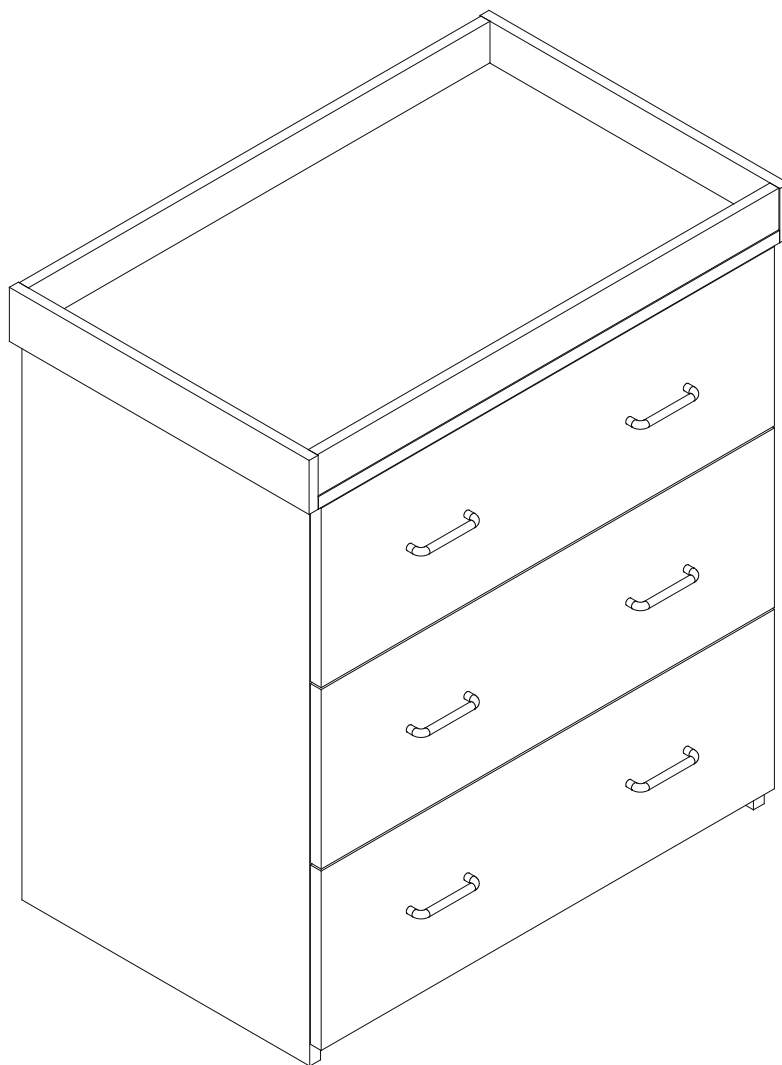

Babymore
more for your baby

LVC: V1/22
Babymore Ltd

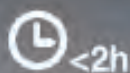

IMPORTANT: READ CAREFULLY AND RETAIN FOR FUTURE REFERENCE

INSTRUCTIONS FOR SAFE USE

The correct use and maintenance of your changer will ensure it gives long and trouble free use.

Please ensure everyone use your changer know how to use it. The safety of your child is your responsibility.

- **WARNING: DO NOT LEAVE THE CHILD UNATTENDED.** The safety of your child is your responsibility
- Check regularly that all the fittings and screws are correctly tightened and are not damaged. Loose screws can pinch parts of the body and clothing resulting in the risk of strangulation.
- Do not use replacement parts that are not recommended or supplied by Babymore
- Do not place your product in the near vicinity of open fires or other sources of strong heat, such as electric or gas fires.
- Always leave your product clean and dry. Wipe away any spillage straight away. Your product can be cleaned with a damp cloth. Never use harsh abrasives, bleach or strong detergents
- Before use, ensure the dresser is on a stable, level surface.
- Do not allow children to climb on the changer.
- Never use the changer if any parts are broken or missing.
- Never pivot or drag the changer on its feet, must always be lifted by at least two people when moved.
- A changing mat is not supplied with this product. We recommend that you only use size 75 x 45cm changing mat with maximum thickness no more than 1 inch (25.4mm). Place the changing mat on the changing surface, evenly within the retaining rails.
- This product is intended for child from birth to 12 months, up to 11kg.
- Designed and manufactured to BS EN 12221:2008 + A1:2013

WARNING: WALL STRAP INFORMATION

- The wall strap is only intended to be used with the Babymore product that is supplied with.
- Never attempt to modify or change the wall attachment strap in any way. Never use any other fitting for attaching the strap to your furniture than those supplied
- Never use the screw provided to attach the strap to the wall. No wall attachments are supplied. This is because the type of fittings required to attach the strap to the chosen wall is determined by the composition of wall. If you are in any doubt about the correct type of fittings to use, consult a professional before attempting to attach the strap to the wall.
- The wall strap must not be used to replace any other fitting supplied with your furniture.
- Furniture falling over is generally due to the surface the furniture is placed on. A warped floor or wall-to-wall carpeting will enable the furniture to rock, so greatly increasing the potential for the furniture to fall. If the furniture is placed on a flat level wood or tiled floor the risk is reduced, but we still recommend the wall strap is fitted.

Thank you for purchasing Babymore. If you need assistance, spare parts or you are unhappy with the goods.
 TEL: 020 3475 5588 EMAIL: customerservices@babymore.co.uk

Improper assembly can result in damage to your furniture or cause harm to your child. Proper assembly is critical to ensure a safe and comfortable end result. Please read all instructions before assembly and keep for future use.

BEFORE ASSEMBLY

- Unpack all the parts and identify them against the components and fittings lists.
- Do not discard any packaging until you are sure you have all the parts and the pack of fittings.
- If you do find any parts are missing or damaged or incorrect, contact customer services via above.
- Read the instructions thoroughly before attempt construct.
- You may find the construction easier with help of another person, in the room for use, on a soft and clean floor so there is no damage caused during construction.
- Follow each stage of construction step-by-step.

FITTINGS

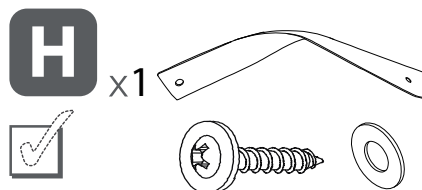
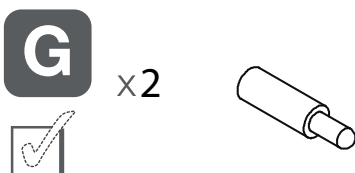
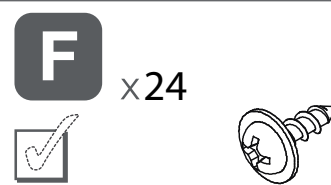
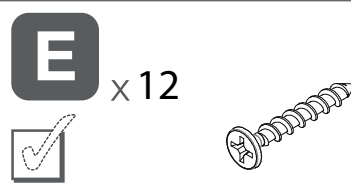
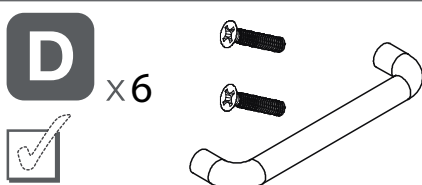
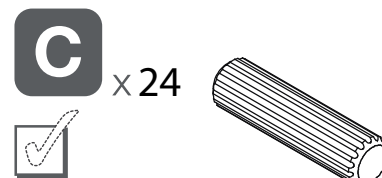
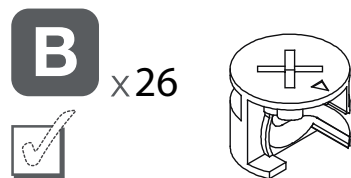
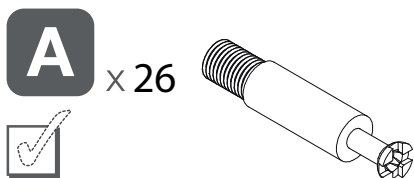

COMPONENTS



x2



x2



x3



x3



x3



x3

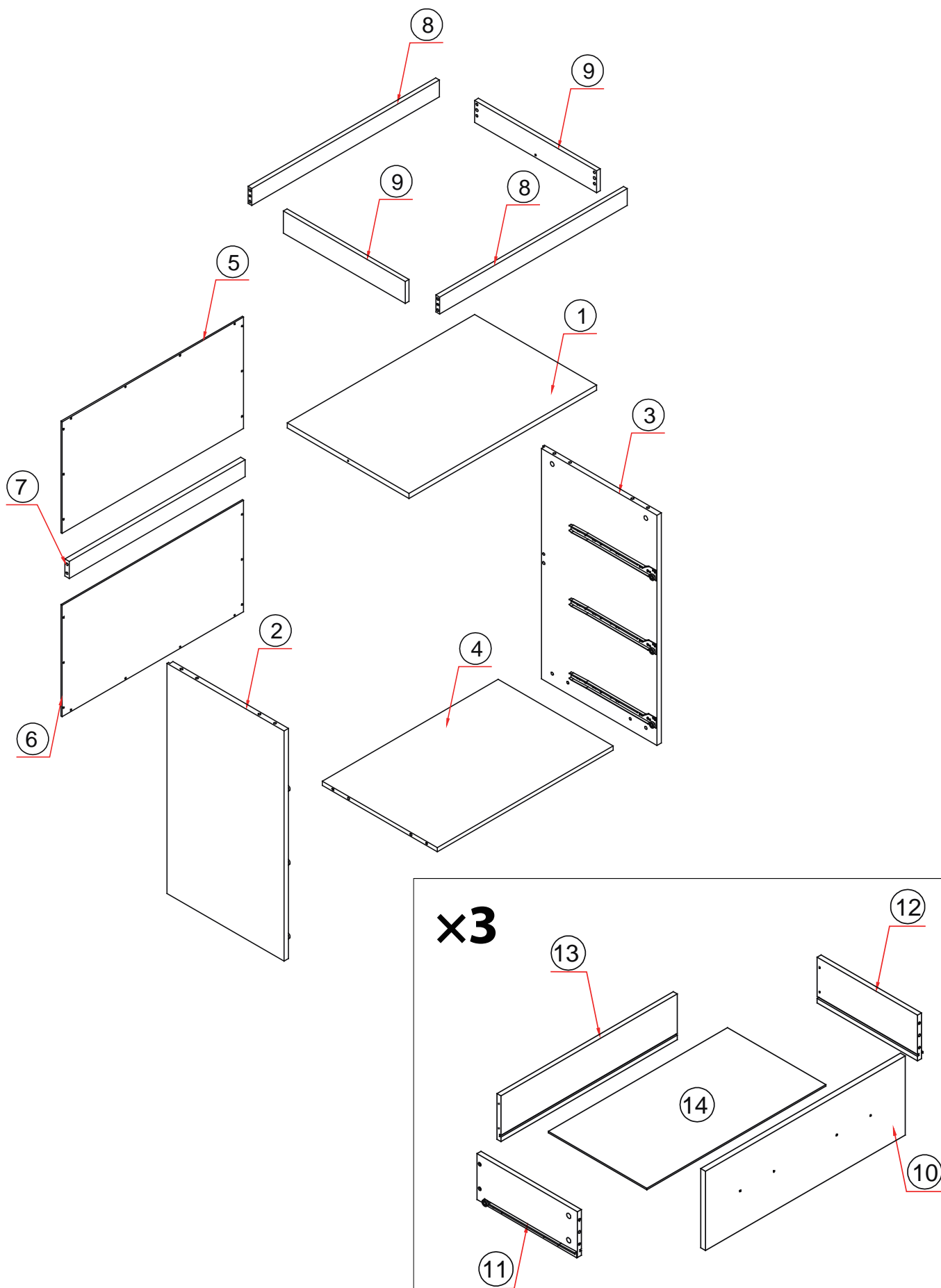

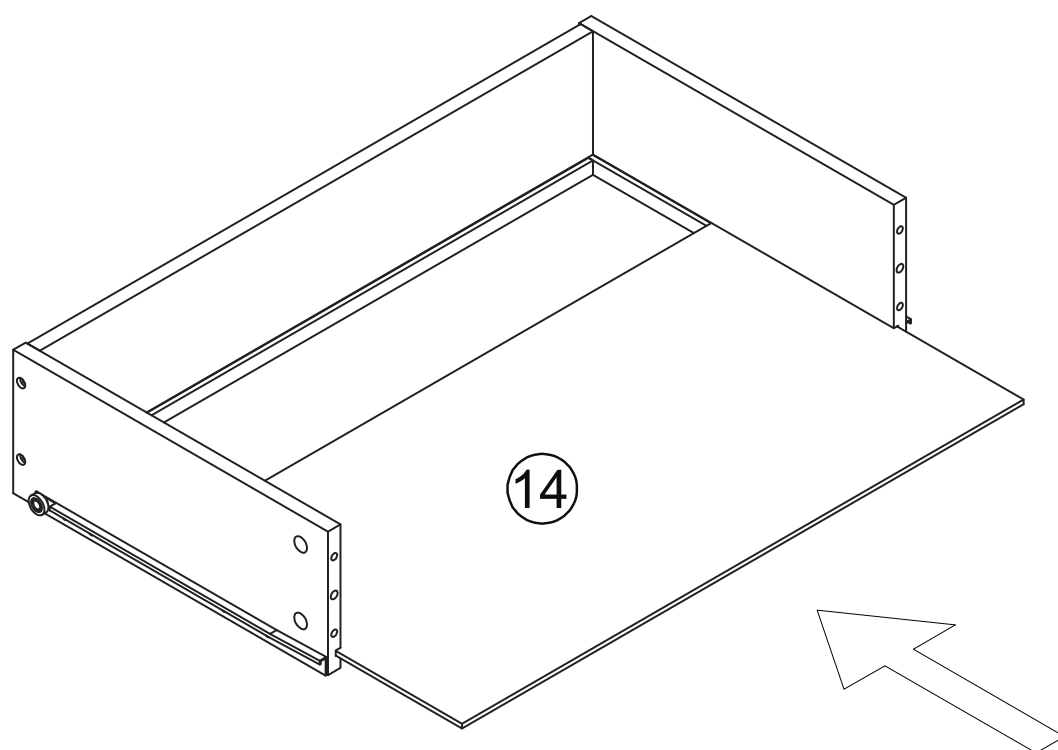
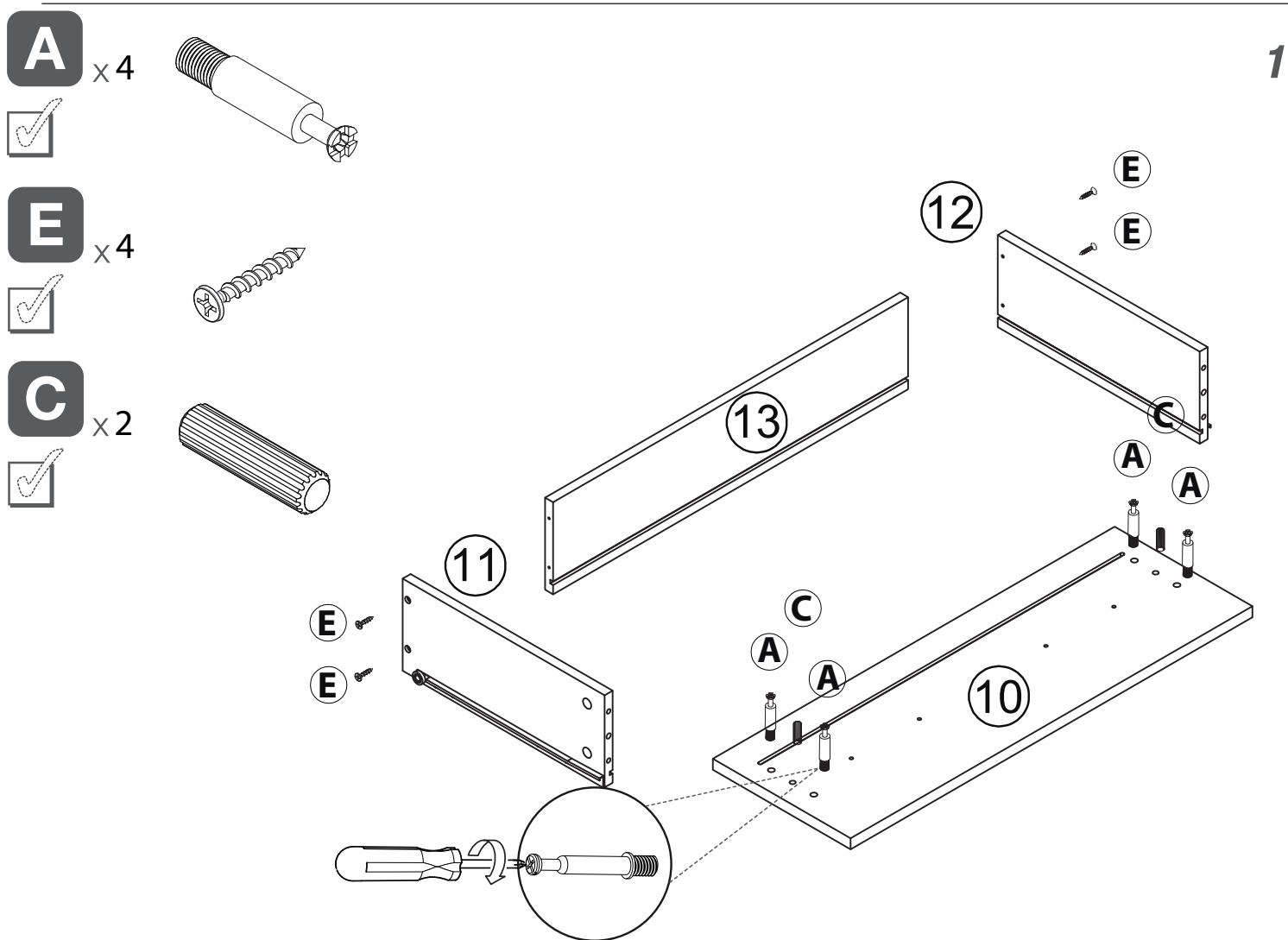

3

B x4

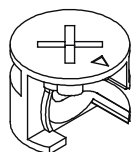

D x2

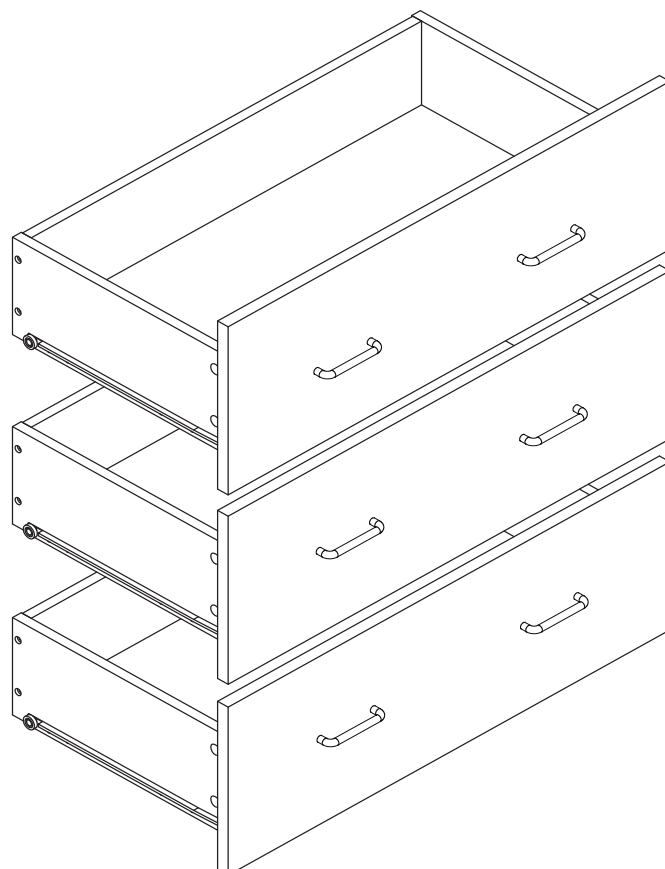
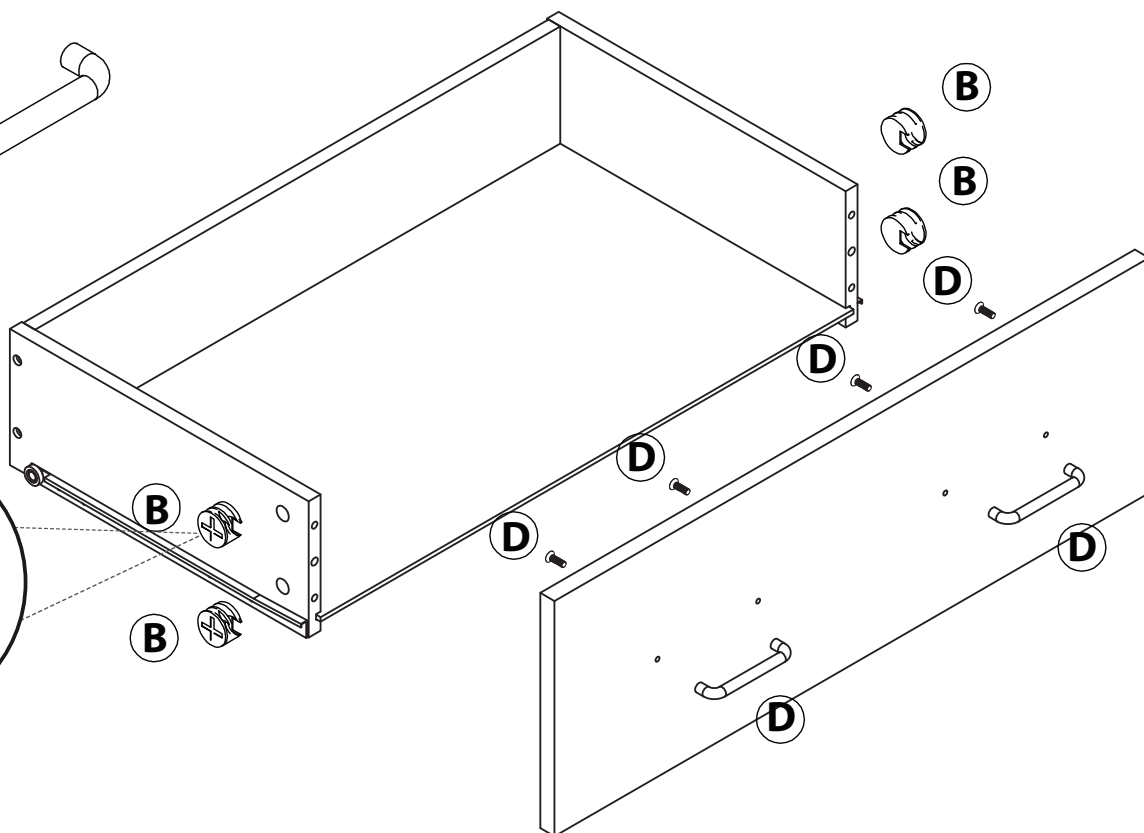
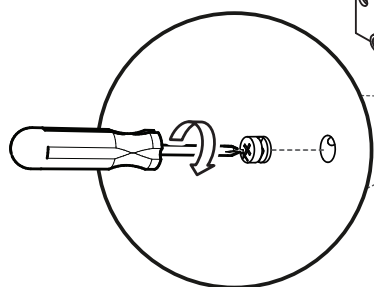
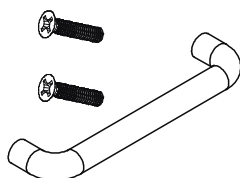

4

A x6

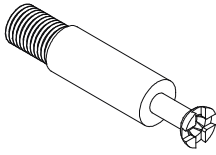

C x6

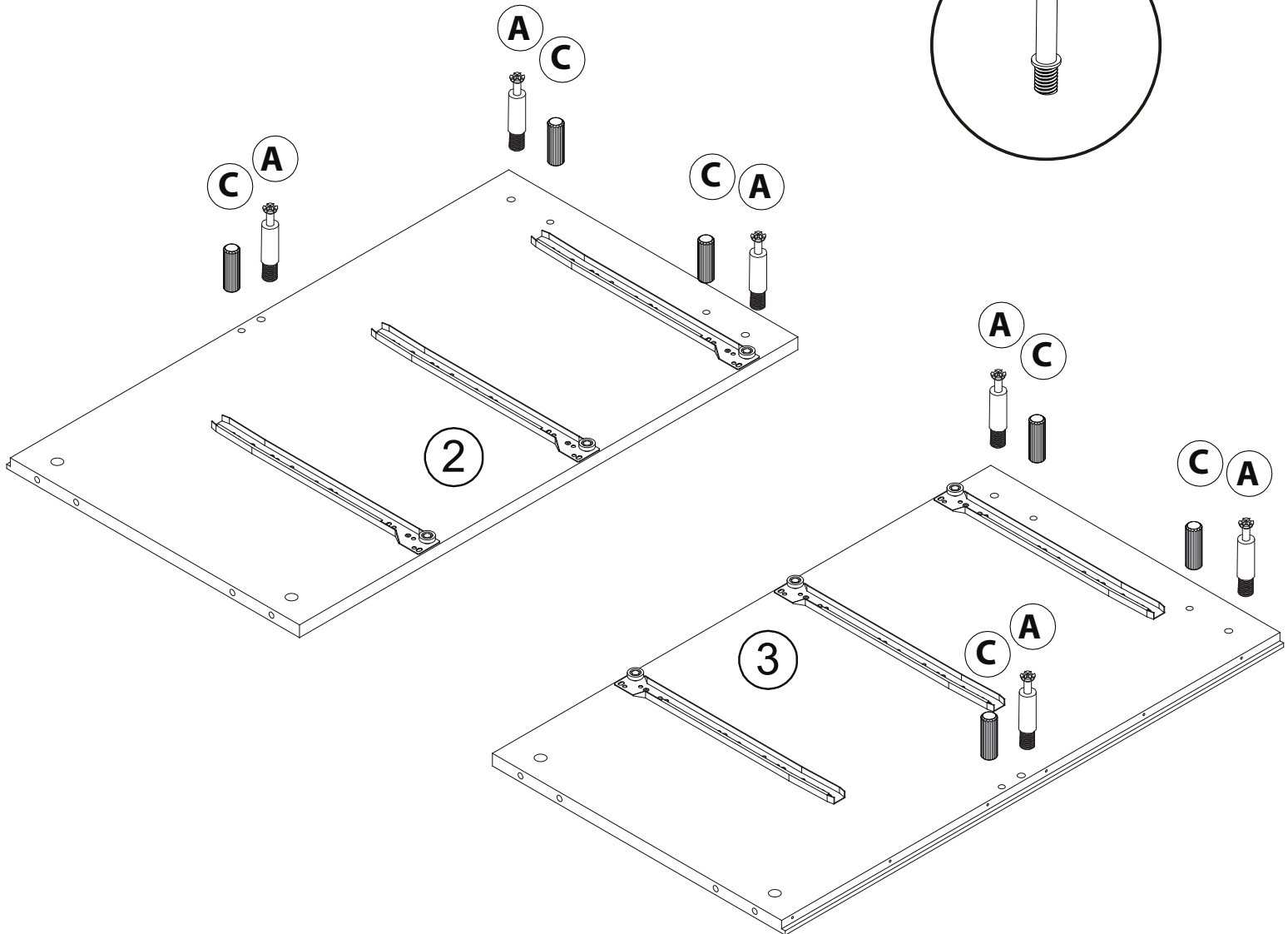
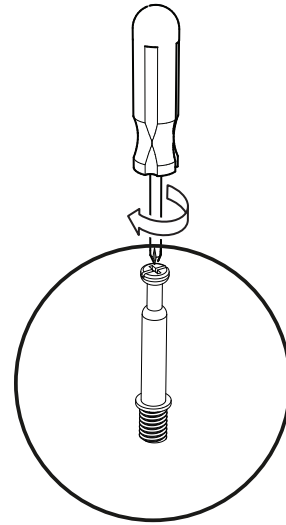
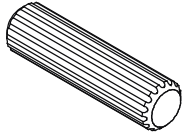

5

B

x6

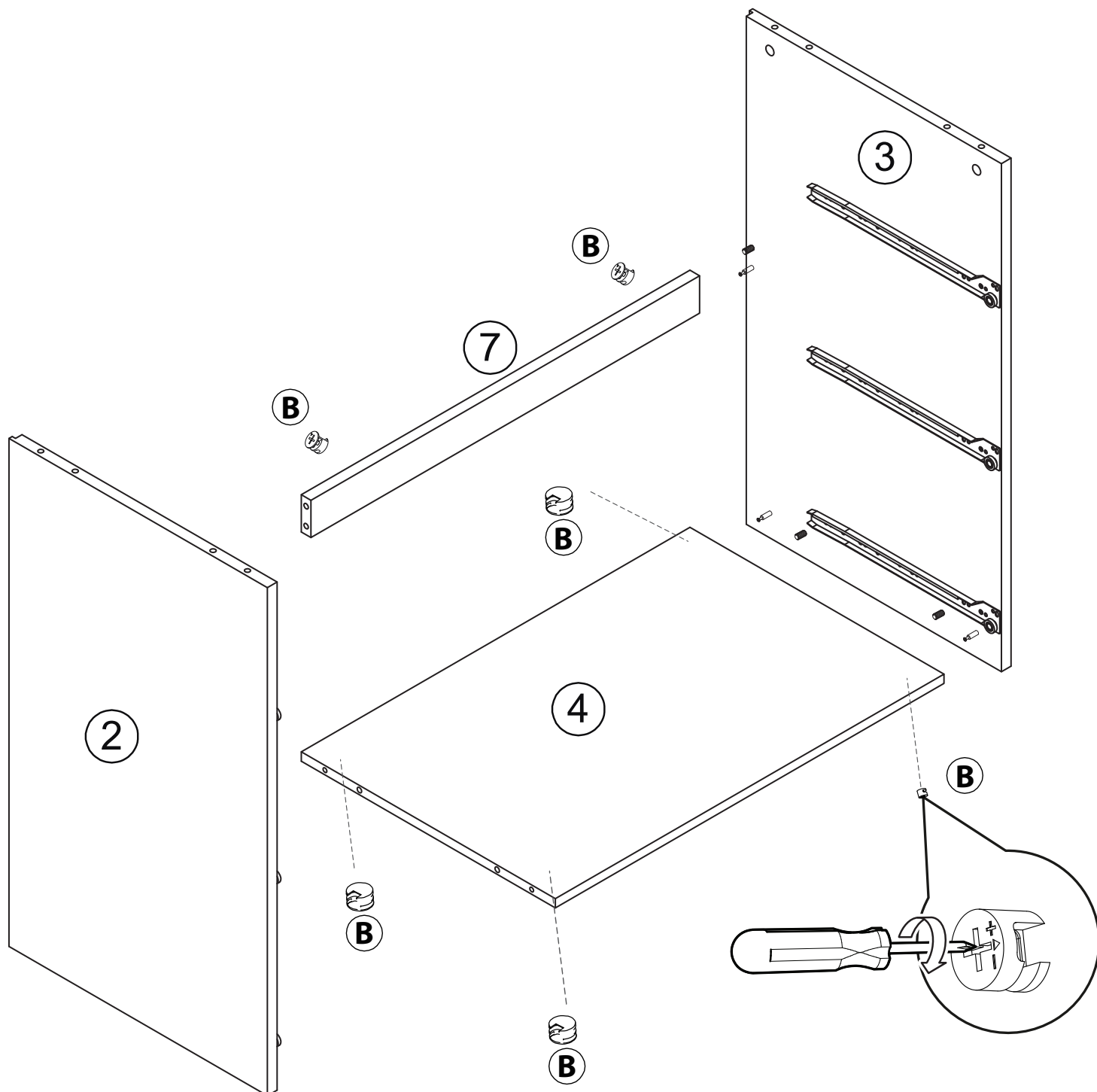
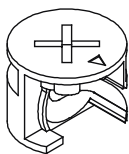

A x4

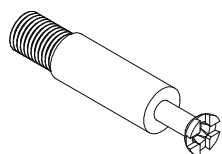

C x4

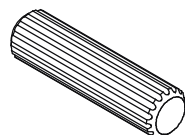

6

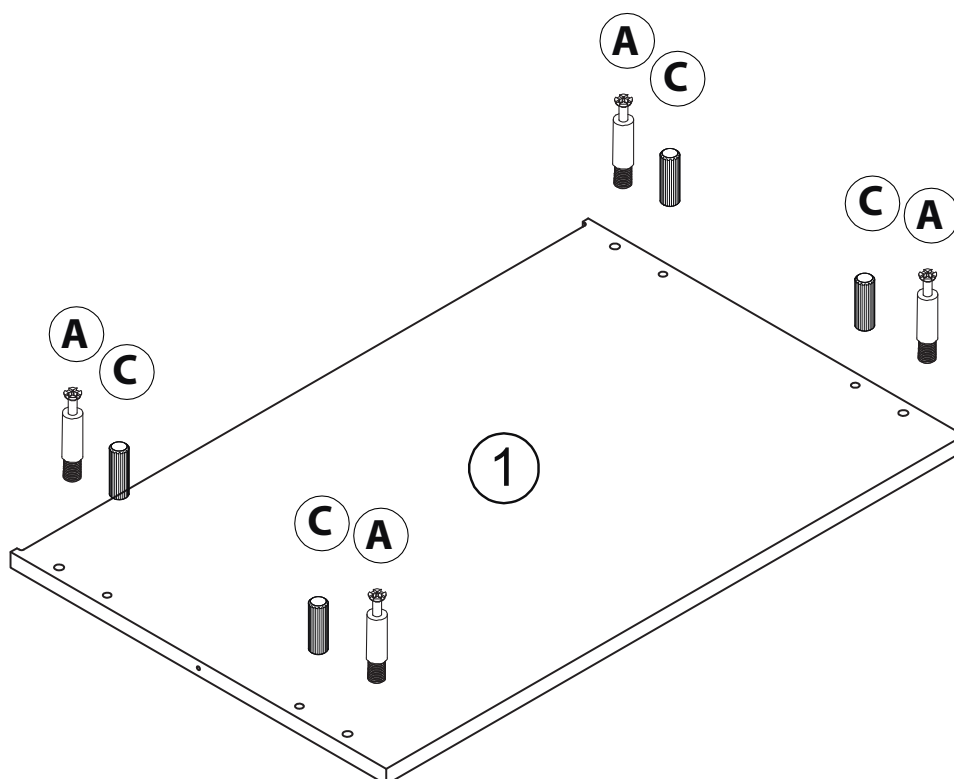

B x4

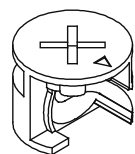

7

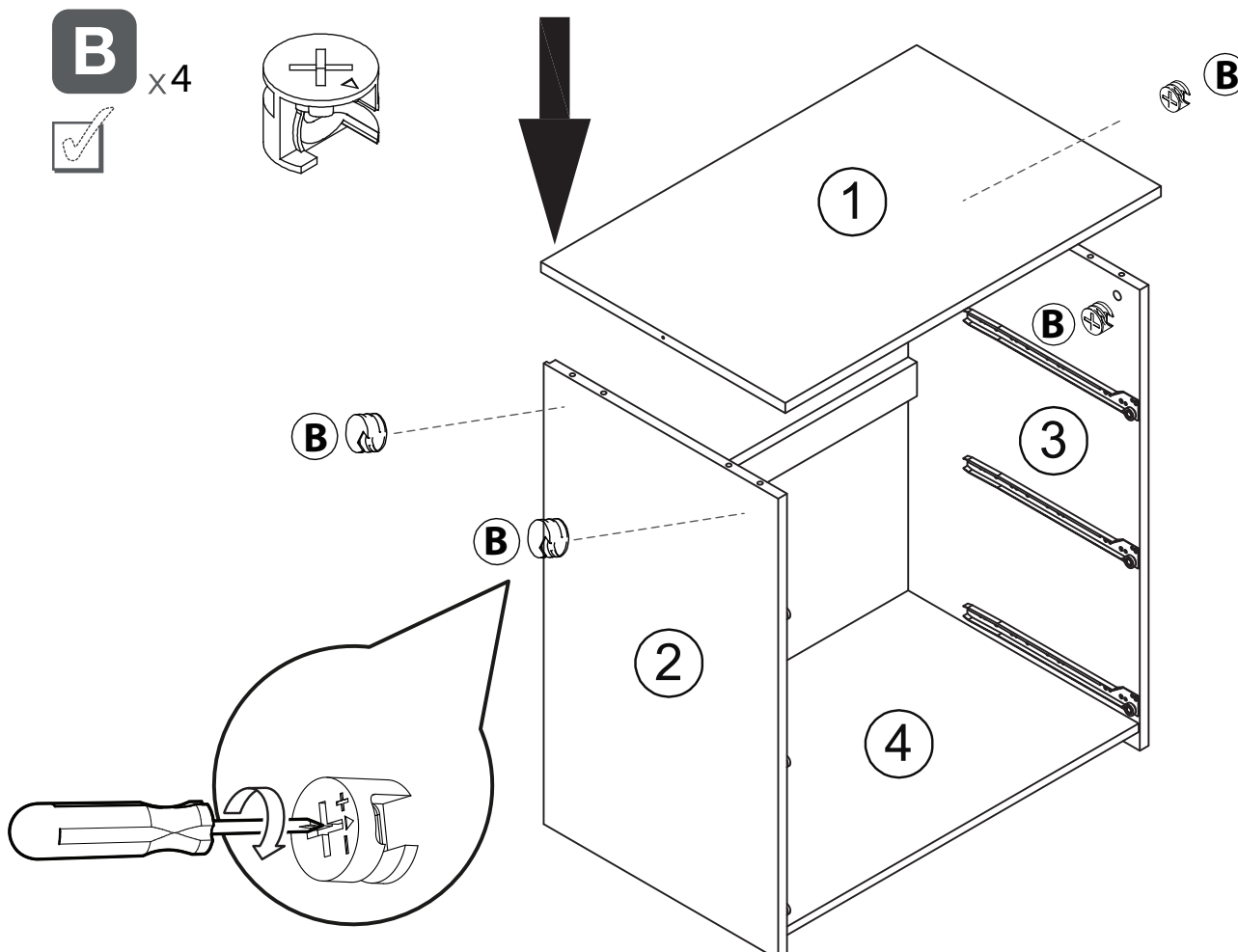

8

F

x24

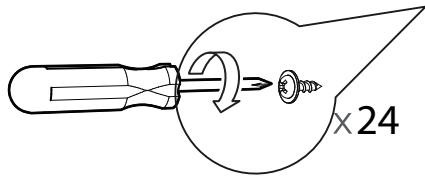
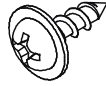

x24

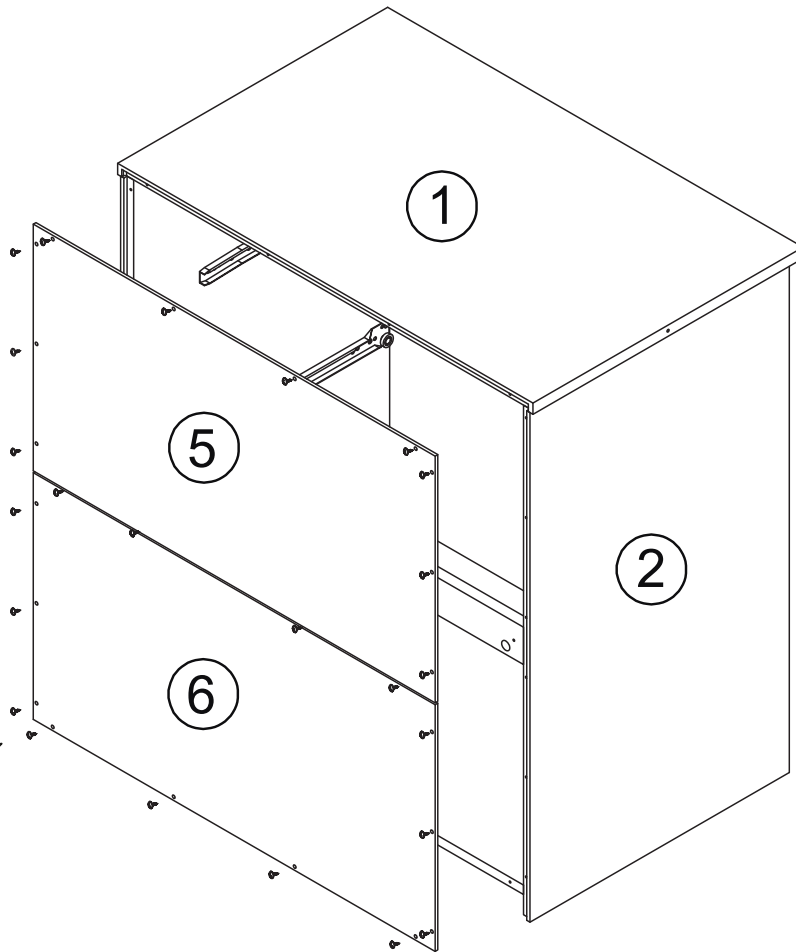

9

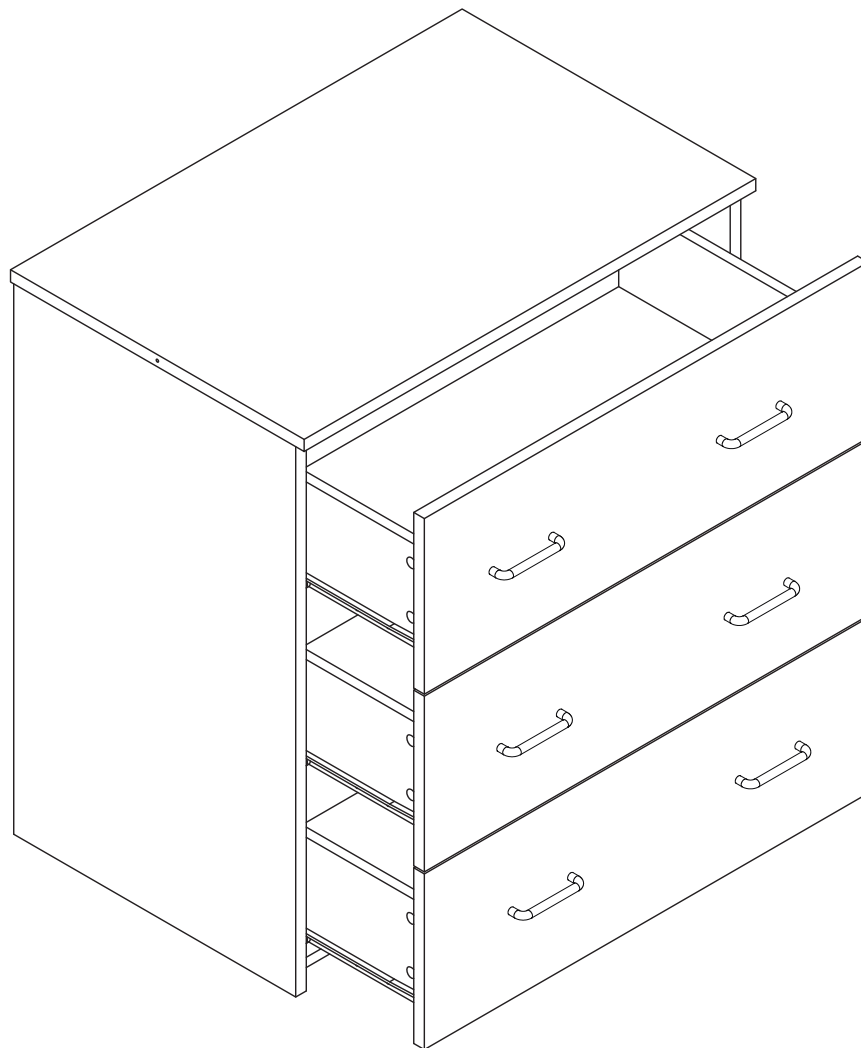

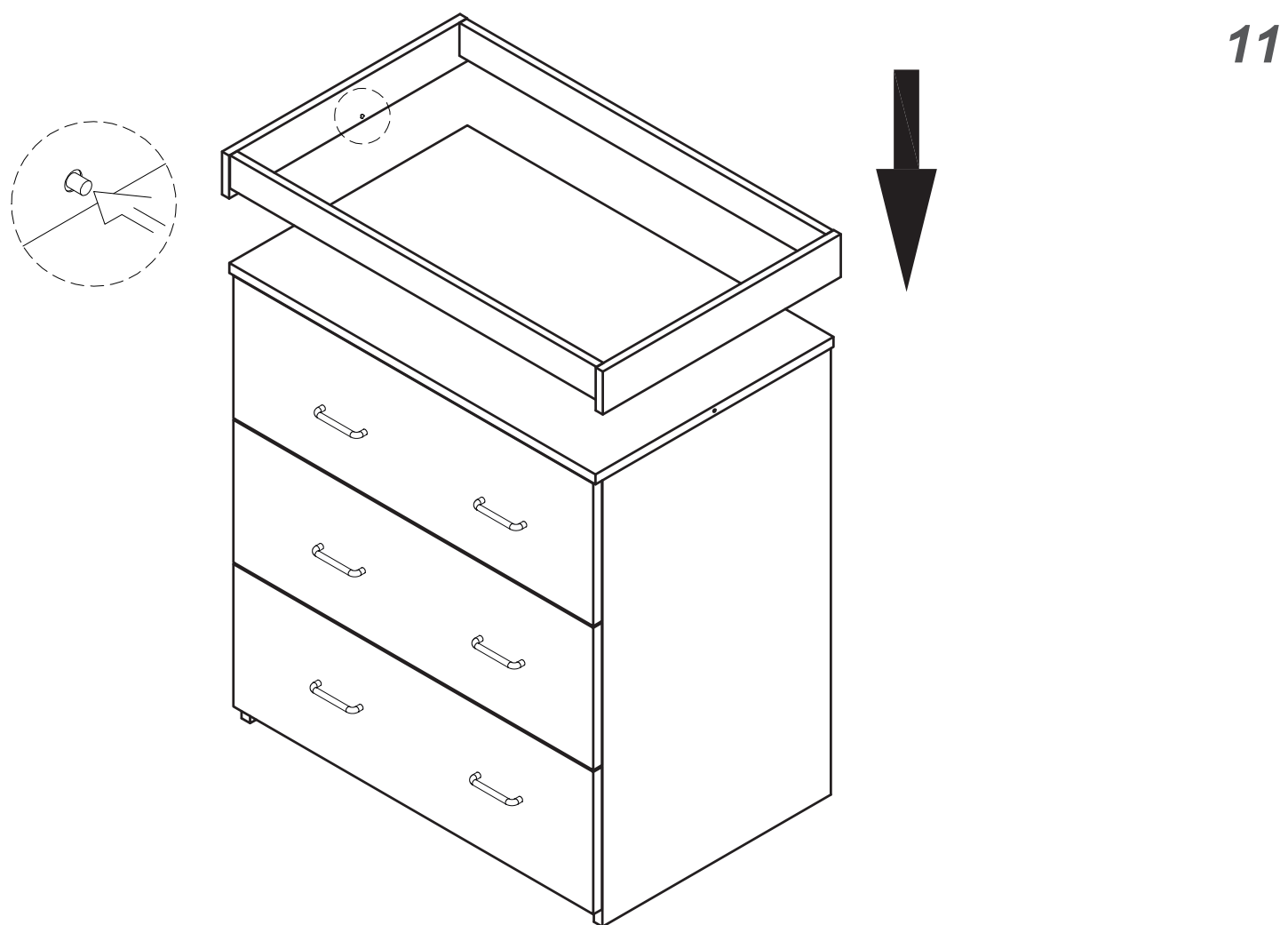
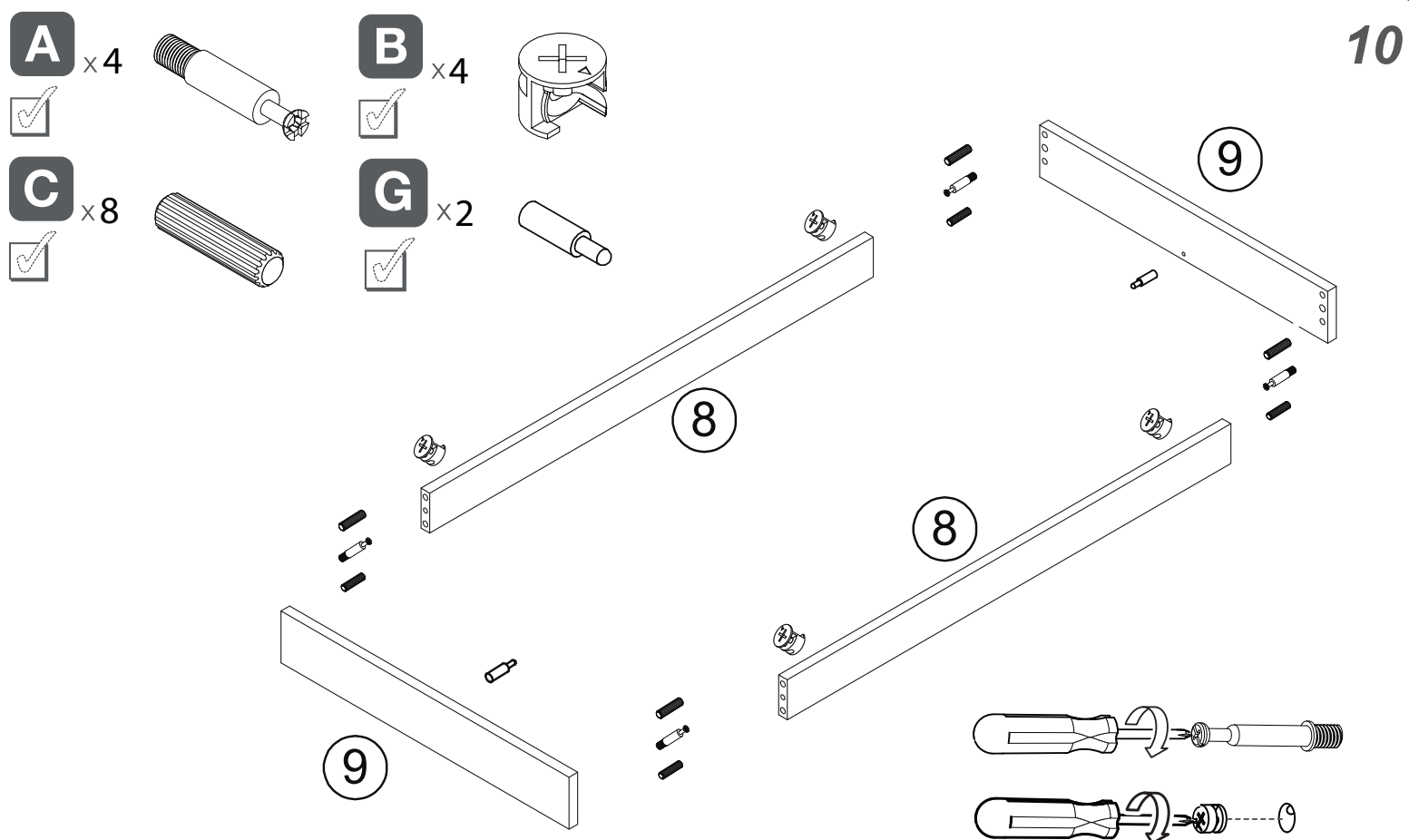

Warning: Never use the screw provided to attach the strap to the wall. No wall attachment fittings are supplied. This is because the type of fittings required to attach the strap to the chosen wall is determined by the composition of the wall. If you are in any doubt about the correct type of fittings to use, consult a professional before attempting to attach the strap to the wall. This hardware is only deterrent. Adult supervision is the only proper deterrent to prevent improper use of the units. Tipping furniture may injure young children. Use of this tipping restraint hardware is highly recommended.

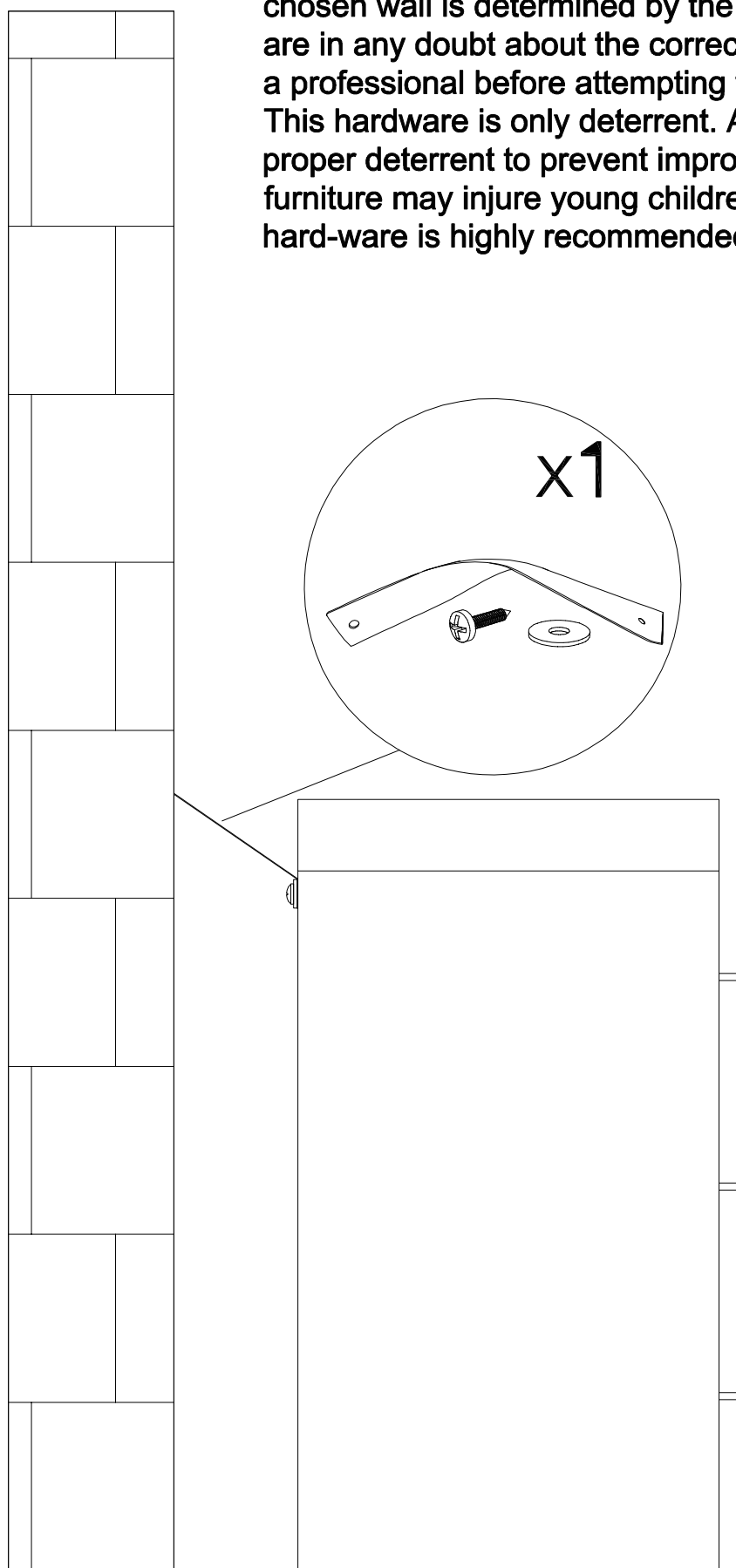

Due to constant updating and improvements, some components may occasionally differ slightly from the diagrams shown in these instructions.

Any spare components should only be thrown away after you have fully constructed your product. After disassembly, it is important to retain all metal fixings and components for reassembly in future.

We reserve the right to change the specifications of any piece of product without prior notice.

CARE & MAINTENANCE

To preserve the hand crafted quality of Babymore furniture, we recommend using a cotton cloth and a non-toxic cleaner. Periodic use furniture polish will maintain the good looks of your furniture. Scuff marks may be removed with damp cloth.

SIX MONTHS LIMITED WARRANTY

We will replace any missing parts at the time of purchase or any defective item within 6 months period from the date of original purchase. Please keep your receipt so that we may process your warranty request. This warranty only covers new units with original packaging and ownership and is not transferable. It does not cover any used, second hand or demo models.

The warranty does not cover any damaged or defective parts that result from installation and assembly, normal tear and wear, negligence, improper use, incidental damages or alterations to the finish, design, part, or fitting of the item. This in no way affects your statutory rights.

Each Babymore item is a unique piece, made of high-quality wood and material. Due to handcrafted nature and use of solid woods, each piece is unique and may contain irregular qualities, these will occasionally be natural markings, miniscule burrs, or slight discolorations, these natural characteristics are inherent in wood and are not considered manufacture defects. Because of this, the merchandise will be considered normal and of good quality and do not merit replacement.

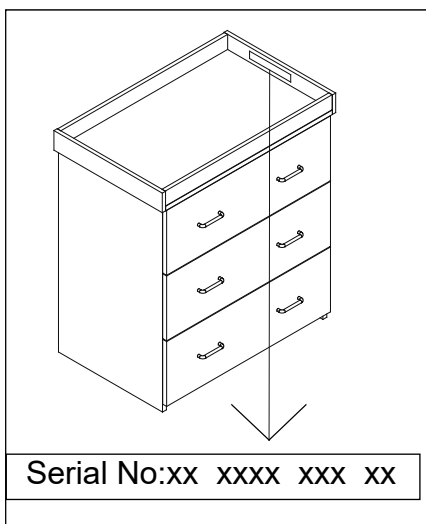

Thank you for purchasing Babymore. If you need assistance, spare parts or you are unhappy with the goods.

TEL: 020 3475 5588

EMAIL: customerservices@babymore.co.uk